

ZEUS Campus Placement Program

Eligibility criteria=60% and Above(For GTU Students 6.75 CPI and Above)

SEATING ARRANGEMENT

Sr. No.	College Name	No. of Students	Room No.	Block No.
1	Lok Jagruti Institute of Computer Applications	80	603	6 (Mechanical Department)
2	Nirma Institute of Technology	20	720	7 (Chemical Department)
3	Rollwala Computer Institute	10	603	6 (Mechanical Department)
4	GLS Institute of Computer Technology	50	AryaBhatta Auditorium	0 (Main Building)
5	Dhirubhai Ambani Institute	15	604	6 (Mechanical Department)
6	L.D. College of Engineering	50	402	4 (Mechanical Drawing Hall)
7	Gandhinagar Institute of Technology	80	811,812	8 (Textile Department)
8	LDRP Institute of Technology	75	969,976	9 (E.C. Department)
9	Shantilal Shah Engineering College,Bhavnagar	21	620	6 (Mechanical Department)
10	VVP College, Rajkot	52	722	7 (Chemical Department)
11	GEC,Gandhinagar	35	615	6 (Mechanical Department)
12	JVIMS	15	723	7 (Chemical Department)
13	Atmiya Institute of Technology and Science, Rajkot	80	720,721	7 (Chemical Department)
14	G.H. Patel College of Engineering	21	959	9 (E.C. Department)
15	M.S. University of Baroda	16	959	9 (E.C. Department)
16	Vishwakarma Government Engineering College,Chandkheda	38	932	9 (E.C. Department)
17	Charotar Institute of Technology,Anand	106	819,820	8 (Textile Department)
18	Dharm Singh Desai Institute of Technology	59	Drawing Hall,Textile	8 (Textile Department)
19	C.U. Shah College of Engineering, Wadhwan	40	903,924	9 (E.C. Department)
20	SVIT,Vasad	78	604	6 (Mechanical Department)
21	Department of Computer Science,Bhavnagar	20	903	9 (E.C. Department)
22	GEC, Rajkot	43	952	9 (E.C. Department)
23	AD Patel Institute, Anand	10	403	4 (Mechanical Drawing Hall)
24	AES Institute of Computer Studies	6	616	6 (Mechanical Department)
25	Birla Vishwakarma Mahavidyalaya	55	634	6 (Mechanical Department)

26	Parul Institute of Engineering Technology	37	403	4 (Mechanical Drawing Hall)
27	SPCE Visnagar	80	616	6 (Mechanical Department)
28	Babaria Institute	43	614	6 (Mechanical Department)
29	RK Engineering College	126	005	0 (Main Building)
30	Ganpat University	30	017	0 (Main Building)
31	CIT Mehsana	22	620	6 (Mechanical Department)
32	Gardi Engineering Rajkot	40	018	0 (Main Building)
33	H.G.C.E.	80	723,724	7 (Chemical Department)
34	Universal College of Engineering Ahmedabad	50	636	6 (Mechanical Department)
	Total	1583		

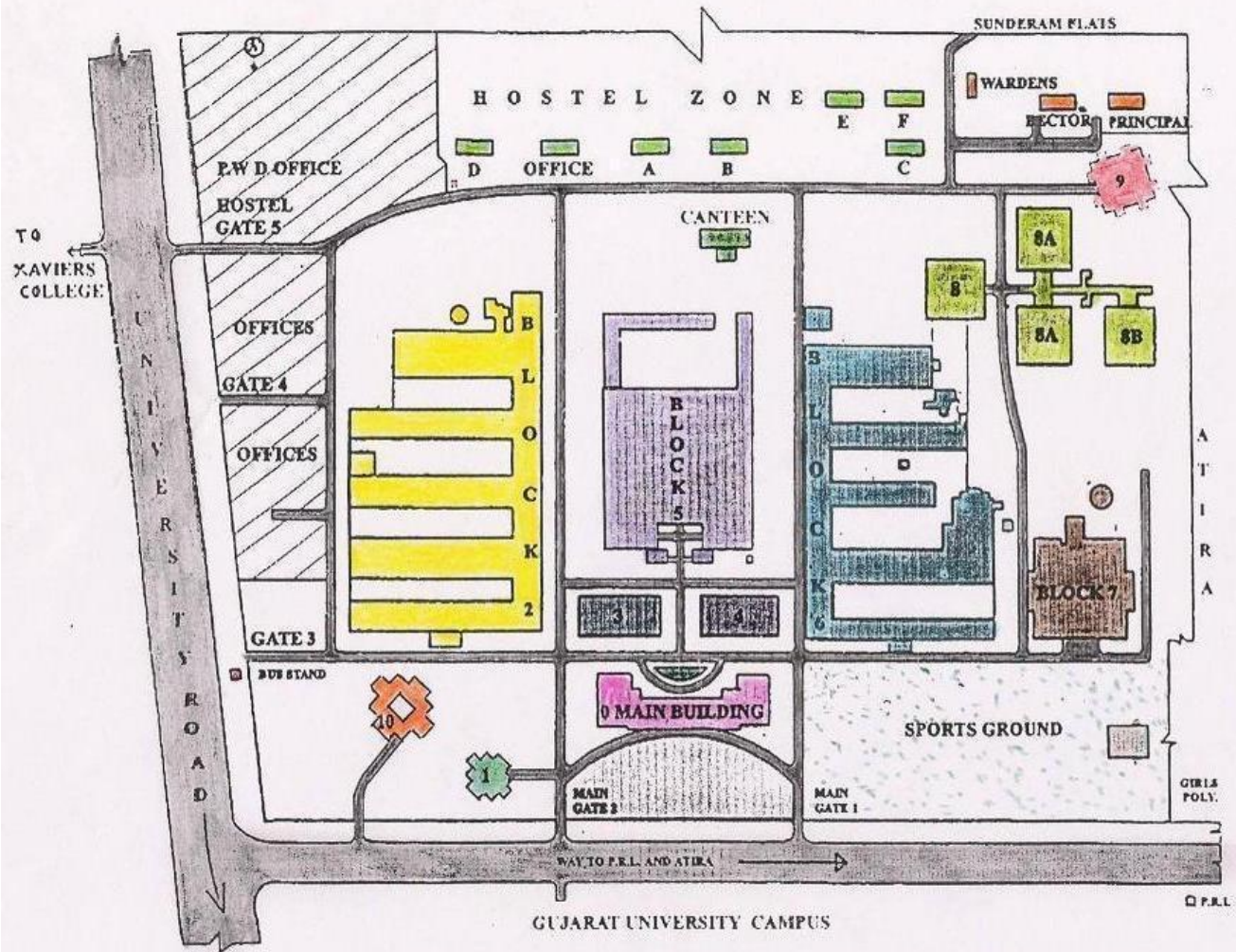

- 0 MAIN BUILDING
PRINCIPAL,
ADM.OFFICE,
MATHS,
CIVIL ENGINEERING,
ROOM No :5
- 1 L.R.C BLOCK
- 2 ELECTRICAL WING
COMPUTER, I.T,
M.C.A, BIO-MEDICAL,I.C
CIVIL,P.G (W.R.M)
- 3 CIVIL DRAWING HALL
- 4 MECHANICAL DRG. HAL
- 5 STUDENTS SECTION,
STUDENTS STORES,
TRANSPORTATIONS LAB
WORK SHOP
- 6 MECHANICAL ENGG,
P.G (CRYO)
P.G (CAD/CAM)
P.G (AUTO)
APPLIED MECH DEPT
P.G (CASAD)
- 7 CHEMICAL ENGG
- 8 TEXTILE TECH
(8.A) T.T LAB
(8.B) DRAWING HALL
- 9 ENVIRONMENT
E.C BUILDING,
RUBBER,PLASTIC
- 10 ADMISSION BLOCK
- ☐ P.W.D OFFICES

LAYOUT PLAN OF L.D. COLLEGE OF ENGINEERING